

# PRIMER PISO

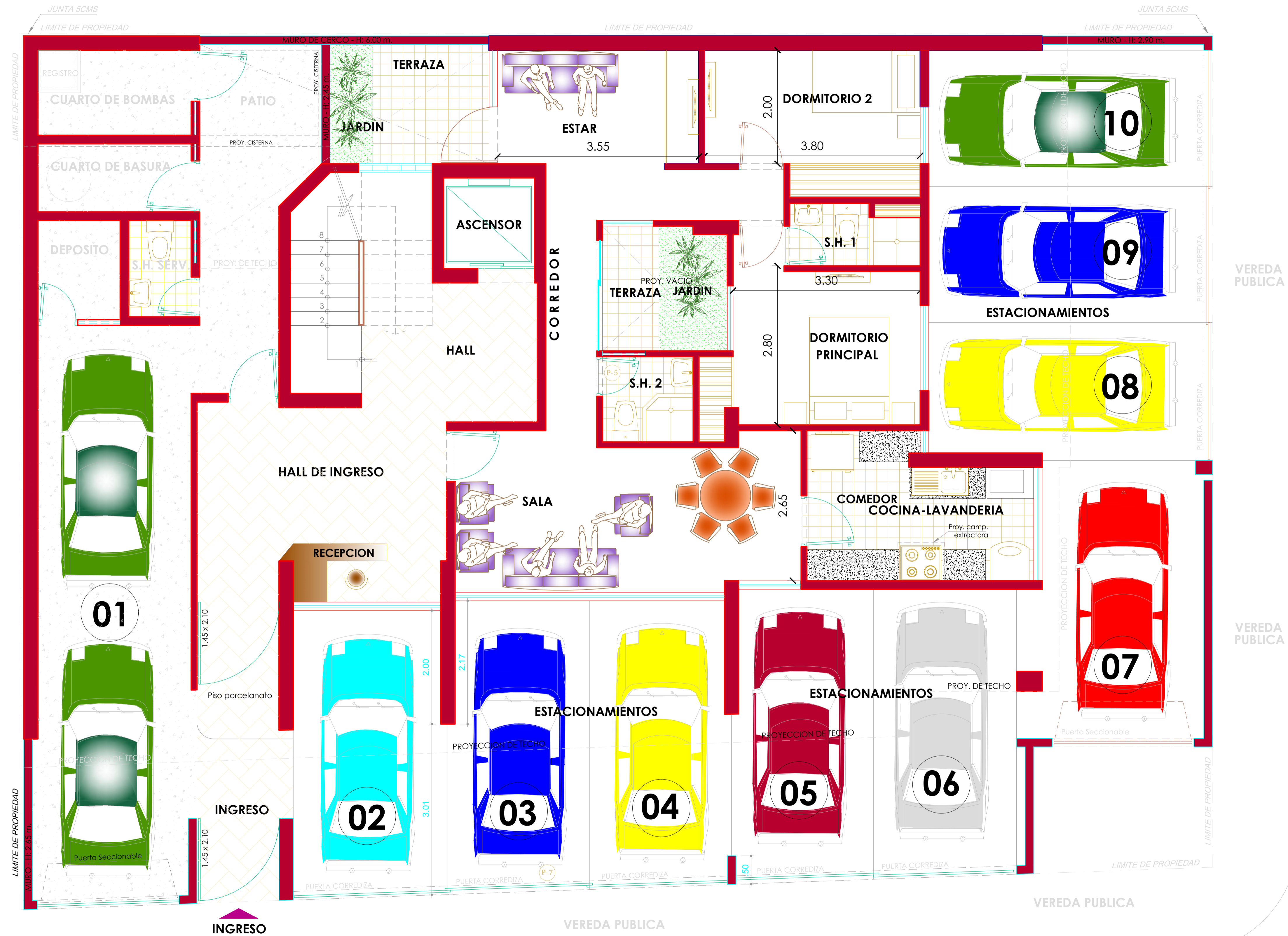

JIRÓN LEONCIO GUIZADO (CALLE TRES)

DPTO. N° 101

AREA TECHADA = 75.00 M2 Aprox.

AREA LIBRE = 6.00 M2 Aprox.

AREA OCUPADA = 81.00 M2 Aprox.

JIRÓN ENRIQUE PARODI (CALLE NUEVE)